



# **Grison Power Engineering**

*Electrical, Civil, Mechanical Supplier & Installation Contractors*



## ***Company Profile***



**Head Office:** House-20\18, 4<sup>th</sup> Floor, Paikpara Staff Quarter, Mirpur-1, Dhaka.

**Rajshahi Office:** House-403, Mothurdanga , Sopura, Rajshahi- 6203

**Service Center:** House -20/18, 4th Floor, Paikpara Staff Quarter, Mirpur-1, Dhaka.

**Factory:** Taltoli, Sreepur, Gazipur.

**Contact #** 01775882040, 01625286825

**E-mail:** [grisonpower24@gmail.com](mailto:grisonpower24@gmail.com) **Web:** [www.grisonpowerbd.com](http://www.grisonpowerbd.com)

# Introduction

---

**Grison Power Engineering – GPE** was established in the year **2020** as Supplier & constructors with an aim to serve the nation professionally in the fields of **Civil, Electrical, Mechanical and LPG Engineering**. Over the years we have completed numerous Commercial & Industrial Projects of National Importance.

Since 2020 **GPE** continues to strive for providing reliable, efficient & cost effective projects to many Local and Multinational Companies on Turnkey Basis. We are committed to follow engineering code of practice/standards with HSE at the top and client's ultimate satisfaction.

**GPE** proudly acclaims to provide the best services and can undertake the responsibility to design, execute and manage the whole project on turnkey basis. Please find our list of services and clientele that might speak of our work quality and experience.

Our commitment with client is also backed up by extensive technical support, after sales service and comprehensive level of stock, for immediate response to customer's requirements. If you have any queries for the pre-qualification of our company, please do not hesitate to contact us. We will be really glad to assist you.

Thanking and assuring you of our best services and Co-operation. Regards,

**Grison Power Engineering**

**Engr. Imran Ali**  
**C.E.O & Founder**

# Company Resume

---

Name	<b>Grison Power Engineering</b>
Business Nature	1) Electrical Contractor 2) Civil Contractor 3) Mechanical Contractor 4) LPG Contractor
Business Form	Sole Proprietorship
Established	Since 2020
Constructor License	Bangladesh Engineering CouncilElectrical
Contractor License	Govt. of Bangladesh
Trade License	Registered
Tin Certificate	Registered
BIN Certificate	Registered
ABC Supervisor Certificate	Registered

**Head Office:** House-20\18, 4<sup>th</sup> Floor, Paikpara Staff Quarter, Mirpur-1, Dhaka.

**Rajshahi Office:** House-403, Mothurdanga , Sopura, Rajshahi- 6203

**Service Center:** House -20/18, 4th Floor, Paikpara Staff Quarter, Mirpur-1, Dhaka.

**Factory:** Taltoli, Sreepur, Gazipur.

**Contact # 01775882040, 01625286825**

**E-mail:** [grisonpower24@gmail.com](mailto:grisonpower24@gmail.com) **Web:** [www.grisonpowerbd.com](http://www.grisonpowerbd.com)

# Services Summary

---

## *Supply & Installation of*

- Electrical Sub - Station
- Diesel / Gas Generator Set
- Generator Limited Auto Power Supply System to Apartments
- Underground Power & Control Cable Laying with its Termination
- Industrial and Commercial Building Electrical Wiring
- UPS System
- Data Networks
- Fire Detection System
- CCTV System
- Industrial & Street Lighting Pole
- Explosion Proof Lighting & Equipment Electrical Wiring System

## Order to Manufacture & Install

- Low Tension Panel
- Motor Control Panel
- Power Factor Improvement Plant
- Auto Changeover Panel
- Generator AMF & ATS Panel
- Power & Lighting DB
- Bus Tie Duct
- Cable Tray
- Cable Ladder

## MECHANICAL ENGINEERING

---

- Pipe Fabrication/Welding/Erection/Insulation
- Structural Fabrication/Welding/Erection
- Firefighting System Installation and its Piping Network
- Air ventilation & Ducting System

# ***ELECTRICAL ENGINEERING***

---

## Supply & Installation of

- Electrical Sub - Station
- Diesel / Gas Generator Set
- Generator Limited Auto Power Supply System to Apartments
- Underground Power & Control Cable Laying with its Termination
- Industrial and Commercial Building Electrical Wiring



- UPS System
- Data Networks



- Fire Detection System



- CCTV System



- Industrial & Street Lighting Pole



- Explosion Proof Lighting & Equipment  
Electrical Wiring System





## *Order to Manufacture & Install*

- Low Tension Panel
- Motor Control Panel
- Power Factor Improvement Plant
- Auto Changeover Panel
- Generator AMF & ATS Panel
- Power & Lighting DB



- Bus Tie Duct



- Cable Tray



- Cable Ladder



# DISTRIBUTION & POWER TRANSFORMER

**GPE** offers a complete range of power and distribution transformers designed to grant the reliability, durability, and efficiency required in utility, industrial, and commercial applications. **GPE's** liquid filled transformers are manufactured in accordance with the most demanding industrial and international standards. Transformers can be used for indoor or outdoor applications and can be provided with off-load and on-load tap changers.

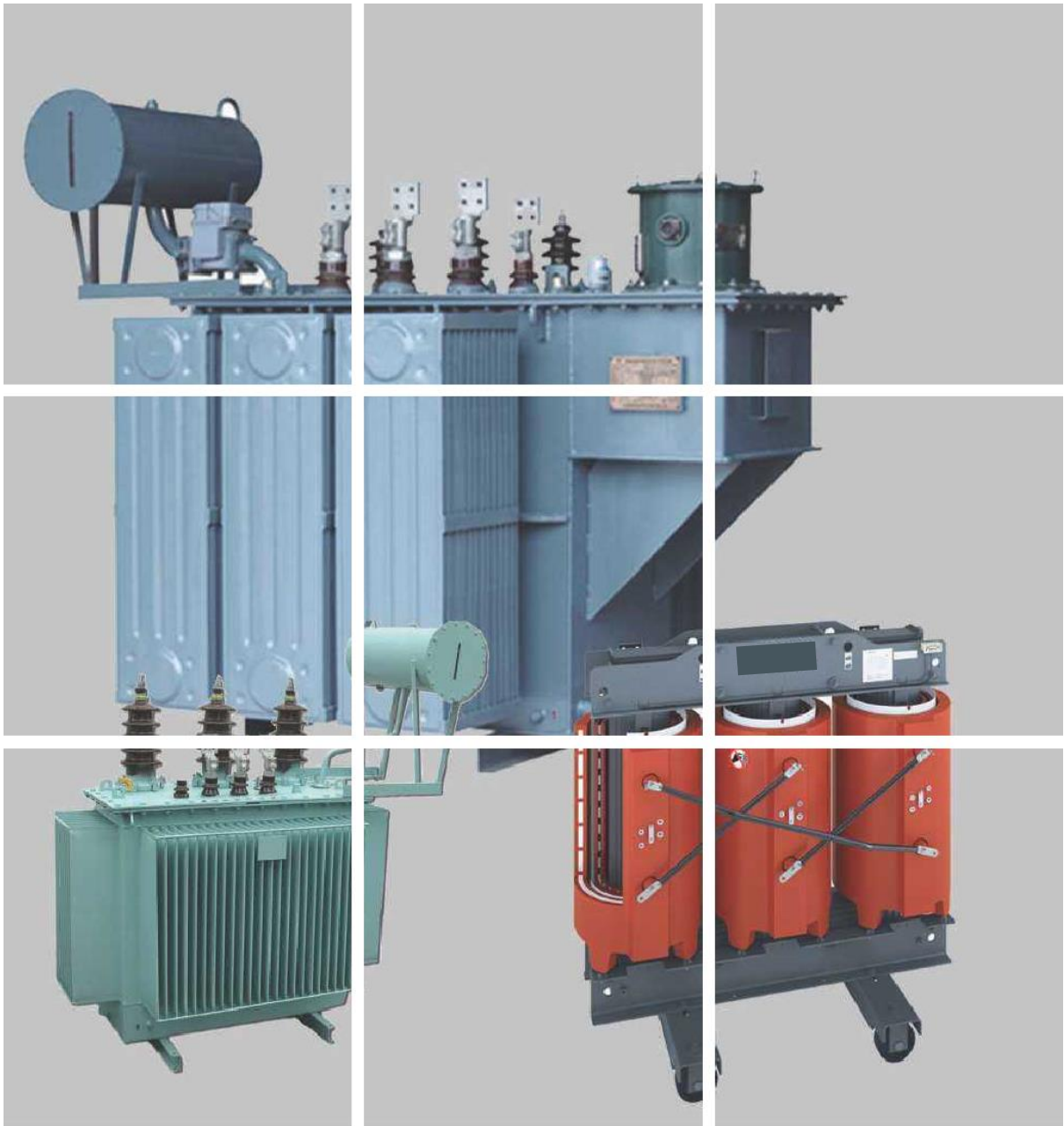



10kV, 50-3000kVA distribution type liquid-filled /dry-type 3-phase transformer

Rated Capacity (kVA)	HV (kV)	Tapping Range	LV (kV)	Vector Group	No Load Loss (W)	On Load Loss (W)	Impedance Voltage (%)	Total Weight (kg)	Height (mm)	Length (mm)	Width (mm)
50	11 33	± 5 ± 5 x 2.5	0.23 0.415	Dyn 11 Yyn0	210	1050	4.0	480	1085	820	605
100					340	1650		660	1220	950	760
150					350	2000		780	1280	965	780
200					500	2450		1050	1350	1200	800
250					670	3250		1100	1405	1235	805
315					700	3900		1390	1540	1450	850
400					850	4600		1450	1620	1530	880
500					1000	5500		1765	1630	1590	885
630					1200	6500		2210	1890	1710	940
800					1300	11000	6	2470	2060	1825	1045
1000					1600	13500		3100	2070	1925	1125
1250					1800	16000		3290	2105	2050	1100
1600					2100	19500		4600	2240	2085	1190
2000					2700	22700		5500	2310	2125	1250
2500					3200	26800		5950	2480	2150	1250
3000					3500	22700		6400	2680	2300	1300
3150					3500	22700		6400	2680	2300	1300

**Think before placing your DEMAND**

Transformer type :	Rated capacity		kVA	
Voatage :	high voltage	kV/low voltage		kV
Tapping range:	±2x2.5% <input type="checkbox"/>	±5% <input type="checkbox"/>	Other <input type="checkbox"/>	
Number of phases:	three-phase	single-phase <input type="checkbox"/>	Other <input type="checkbox"/>	
Frequency :	50HZ <input type="checkbox"/>	60HZ <input type="checkbox"/>	Other <input type="checkbox"/>	
Connection group :	Yyn0 <input type="checkbox"/>	Dyn11 <input type="checkbox"/>	Other <input type="checkbox"/>	
Impedance voltage :	4% <input type="checkbox"/>	6% <input type="checkbox"/>	Other <input type="checkbox"/>	
Cooling--down method :	self-cooled AN <input type="checkbox"/>	Air cooling <input type="checkbox"/>		
Protecting grade of outer casing :	IP00 <input type="checkbox"/>	IP20 <input type="checkbox"/>	IP23 <input type="checkbox"/>	Other <input type="checkbox"/>
Method of incoming and outgoing line:				
	Incoming line to lower part and outgoing line from upper part			<input type="checkbox"/>
	Incoming line to upper part and outgoing line from upper part			<input type="checkbox"/>
	Incoming line to lower part and outgoing line from side part			<input type="checkbox"/>
	Other			<input type="checkbox"/>

**Comminucation / Remort Operation/Protection:**

WTI ☐ OTI ☐ OLI ☐ IOT (Internet of thought) ☐

Annunciator for comminucation ☐ OLTC ☐ RTCC ☐

# LV & MV AUTO VOLTAGE REGULATOR (AVR)

**Application:** Over & Under Voltage Stabilisation Protection for Medical Equipment, Buildings, Factories, Computers, Servers, Telecom Units & Satellites/VSAT.

**Standards:** IEC 61131-2

**Parameters:**

- Rated voltage: 0.415kV to 33kV
- Rated current: upto 2000A
- Rated short-circuit breaking current: upto 100kA

**Features:**

- Compact Design, Minimum Power Losses
- Better Efficiency, Low Response Time
- Low Input ranges can be stabilized in High Ratings
- Low Maintenance, Trouble Free Operation
- Long Service Life, Space Saving, Reduced Installation Cost
- Reduction in Electricity Bill
- Bypass Switch: The AVR shall be provided with an integral break before make rotary bypass switch.



# HT SWITCHGEAR



**Application:** for control and protection of 12kV to 132kV power system.

**Standards:** IEC 62271-100

**Parameters:**

- Rated voltage: 12kV-132kV.
- Rated current: 2000A.
- Rated short-circuit breaking current: upto 100kA (3sec).

**Features:**

- High breaking capacity.
- Secure and reliable operation.
- Applicable for frequent operation.
- Easy or free of maintenance.

## MV & HV RING MAIN UNIT (RMU)

**Application:** for control and protection of 12kV to 132kV power system.

**Standards:** IEC 62271-100

**Parameters:**

- Rated voltage: 12kV-132kV.
- Rated current: 2000A.
- Rated short-circuit breaking current: upto 100kA (3sec).

**Features:**

- High breaking capacity.
- Secure and reliable operation.
- Applicable for frequent operation.
- Easy or free of maintenance.



## MV & HV LOAD BREAK SWITCH (LBS)



**Application:** for making and breaking of load current, over-load current and short-circuit current to control and protect the circuit and transformer, etc. in power distribution system.

**Standards:** IEC 60265-1, IEC 62271-105.

**Parameters:**

- Rated voltage: 12-36kV.
- Rated current: 630-1250A.
- Rated breaking current 01 closed loop: 630A.
- Rated current of the fuse: upto 125A.

**Features:**

- Indication of the active contact to show the operation status of the switch.
- High Insulation level.
- Fully sealed and reliable operation.

# GAS INSULATED SWITCHGEAR (GIS)

**Application:** for power substations, especially substations in city center, contaminated region and also hydropower stations.

**Standards:** IEC 62271-203

**Parameters:**

- Rated voltage: 72.5-145kV.
- Rated current: 1250-4000A.
- Rated breaking current: upto 40kA (3sec).

**Features:**

- Compact design, three phases in common tank, less installation area.
- Rated breaking current 40kA for the circuit breakers.
- Spring mechanism during the operation without oil and gas.
- High operation reliability, less maintenance.
- High anti-seismic capability.
- Meet customer requirements by modular design.



# AIR-INSULATED RING MAIN UNIT (AIS)



**Application:** in the system of 50Hz. voltage up to 12W, current up to 630A, for power distribution, circuit control and protection.

**Standards:** IEC 62271-200

**Parameters:**

- Rated voltage: 3.6-12kv.
- Rated current: 630A
- Rated short-circuit breaking current: 125A

**Features:**

- Compact design.
- Easy operation and installation
- Reliable interlock
- Less Maintenance.

# AUTOMATIC CIRCUIT RECLOSER (ACR)

**Application:** Automatic circuit reclosers are recognized by electric utilities throughout the world as an essential device for achieving their prime goal. Reclosers sense and interrupt fault currents and automatically restore service after momentary outage.

**Standards:** ANSI standards: C37.60 and C37.85 and ANSI Guide C37.6

**Parameters:**

- Maximum voltage: 15.5 kV to 38.0 kV
- Rated continuous current: 630A
- Short circuit current, symmetrical: 12.5kA

**Features:**

- Reliable, economical overcurrent protection, advanced metering, and automation systems for distribution circuits.
- Available with two configuration options: control-powered interface and auxiliary-powered interface
- Designed and tested to be compatible with Eaton's Cooper Power series three-phase recloser controls
- Compact and lightweight, easily installed on poles or in substations, mounting equipment is available
- Recloser and control accessories enable further tailoring of the protective program to achieve maximum system operating flexibility



# AIR BREAK SWITCH (ABS)



**Application:** The Gang operated load break switches are meant for outdoor application and are suitable for horizontal or vertical mounting. They are designed for satisfactory performance in harsh atmospheric conditions of high/low temperatures & humidity. Their primary function is to isolate a 33kV, 3 Phase network.

**Standards:** IEC 60129

**Parameters:**

- Maximum voltage: 15.5 kV to 38.0 kV
- Rated continuous current: 1600A
- Short circuit current, symmetrical: 12.5kA

**Features:**

- Resilient, higher BIL silicone rubber insulators
- Maintenance free stainless steel/brass bearings
- Unitized construction: aluminum, steel or fiberglass
- Factory adjusted, ready to mount
- Meets all applicable NEMA and ANSI standards.

# SURGE ARRESTER

**Application:** For protecting rated voltage up to 500kV power transmission & distribution system from over-voltage.

**Standards:** IEC 60099-4

**Parameters:**

- Rated voltage 0.22kV-500kv.

**Features:**

- 3-36kV composite surge arresters KEMA certified.
- GIS metal oxide surge arrester, composite metal oxide surge arrester and porcelain metal oxide surge arrester available.
- Easy installation and maintenance.
- Good sealing capability to ensure reliable operation.
- Protection and reliability of the surge arrester have been greatly enhanced.



# INSULATOR

**Application:** for rated voltage up to 500kV power transmission lines supporting or suspending.

**Standards:** IEC- 61109

**Parameters:**

- Rated voltage 10kV-500kv.

**Features:**

- Long rod polymer insulator, polymer pin insulator, polymer post Insulator, and line post insulator available.
- Secure and reliable operation on high mechanical strength.
- Compact design and light in weight which is convenient for transportation.  
Good anti - vibration capability  
Good anti-moisture capability
- Good electric performances.
- High arm-aging performances which is perfect for utilization under conditions of high altitude.
- Easy for maintenance.
- KEMA Certified.





# VOLTAGE / POTENTIAL TRANSFORMER (PT)

**Application:** for power voltage measurement and relay protection in voltage up to 500kV AC 50Hz power system.

**Standards:** IEC 60044-2

**Ratings:**

- 0.22kV-500kV

**Features:**

- Reliable operation
- Reliable insulation capability
- High measurement accuracy.
- Maintenance-free.
- Reliable scaling performance.



# CURRENT TRANSFORMER (CT)



**Application:** for power, current measurement and relay protection in voltage up to 500kV AC 50Hz power system.

**Standards:** IEC 60044-1

**Ratings:**

- 0.22kV-500kV.

**Features:**

- Reliable operation.
- Reliable Insulation capability.
- High measurement accuracy.
- Reliable current-carrying capability.
- Maintenance-free,

# AUTO TRANSFER SWITCH (ATS)

**Application:** Multiple utility services may be used as an emergency or standby source of power. Required is an additional utility service from a separate source and the required switching equipment.

**Standards:** IEC 60129

**Parameters:**

- Maximum voltage: .415 kV to 38.0 kV
- Rated continuous current: 16 to 6300 Amperes
- Short circuit current, symmetrical: Upto 100kA

**Features:**

- Mechanical switching interlock
- Electronic switching interlock
- Protection fuses
- Terminal blocks for control connections
- Terminal blocks or bars for mains-genset connections
- Switching state displayed externally
- Steel panel coated with thermo-setting powder, with key



# MANUAL TRANSFER SWITCH (MTS)



**Application:** The manual changeover switch is wired into your electrical distribution board (DB) in your premises allowing it to power to everything or just specific circuits if wired this way.

**Standards:** IEC 60129

**Parameters:**

- Maximum voltage: .415 kV to 38.0 kV
- Rated continuous current: 16 to 3200 Amperes
- Short circuit current, symmetrical: 12.5kA

**Features:**

- Manually switch from Mains to Gen and back
- Indicator lights for Mains and Gen
- Strong protective enclosure
- Genset won't start automatically
- Control over when your genset runs

# LT SWITCHGEAR PANEL

**Application:** for circuit control, protection, monitoring and power distribution in power distribution system.

**Standards:** IEC 60439

**Parameters:**

- Rated insulation voltage: 1000V.
- Rated operational voltage: AC 220V/440V/690V

**Features:**

- Rated current up to 10000A. high impact resistance and high protection level.
- Efficient distribution circuit configuration. A single standard panel can be installed with requier circuits.
- Maintenance-free. High safety protection performance. protection degree at the enclosure can be up to Ip54.
- Raw material is non-CFC and non-halogen. which is environment-friendly.
- Structural design and material selection greatly pay attention to preventing the production of arc.
- Modular design and flexible assembly.



# AUTOMATIC POWER FACTOR CORRECTION PANEL (APFC/PFI)

**Application:** The Automatic Power Factor Correction Panel with 30 sensing and correction is the ideal solution for larger loads and accurate correction to maintain high Power Factor, reduce KVA requirement and save Power.

**Standards:** IEC 60439

**Parameters:**

- Rated insulation voltage: 1000V.
- Rated operational voltage: 690V.

**Features:**

- Modular design, Non-compartmentalized,
- Indoor, Floor mounted Top & bottom cable entry.
- Minimum joints hence better reliability and lower losses.
- Special cables used hence withstands high temperature
- Step protection MCCB & Fuse
- Step switching, Microprocessor controlled relay
- Capacitor duty contactors with Damping Resistors.
- Switching option - Auto or manual, Protection class IP42



# MOTOR CONTROL CENTER (MCC)

**Application:** A motor control center (MCC) is an assembly to control some or all electric motors in a central location. It consists of multiple enclosed sections having a common power bus and with each section containing a combination starter, which in turn consists of motor starter, fuses or circuit breaker, and power disconnect.

**Standards:** IEEE 1683-2014, IEC 61439

**Parameters:**

- Maximum voltage: 0.220 kV to 0.690 kV
- Rated continuous current: 16 to 3200 Amperes
- Short circuit current, symmetrical: 12.5kA

**Features:**

- Increase Customer Efficiency and Productivity
- Improved Quality of Output through Atomization of Processes
- Reduce Waste and Scrap
- Increase Process Up-Time
- Well Documented, Aesthetically Pleasing, and Easy to Troubleshoot in the Field
- All Electrical Motor Control Panels built to NFPA 79 and UL Specifications with Safety in Mind
- Operator Friendly Motor Control Panels
- One Year Parts and Labor Warranty on all Electrical Control Panels and Control Systems
- We Guarantee our Motor Control and Automation Systems 100%



## GENERATOR CONTROL & SYNCHRONIZATION PANEL

**Application:** Synchronization panels are mainly designed and used to meet power system requirements. These panels function both manually and with an automatic synchronizing function for one or more generators or breakers.

**Standards:** IEC 60439

**Parameters:**

- Rated insulation voltage: 1000V.
- Rated operational voltage: 690V.

**Features:**

- 3-pole or 4-pole system as required
- Various combinations of load transfer by ACBs, MCCB or Contactors
- Protection class up to IP 54, Load sharing/load shedding
- Automatic and manual synchronizing
- Factory built to client's specifications, Ratings up to 6000A
- Control functions available for engine monitoring, warm-up and cool down periods, emergency shutdown, multi attempt engine start control, and engine test runs.



# DOMESTIC & INDUSTRIAL UPS



**Application:** Industrial UPS with single or three phase output are designed for the harsh industrial environment.

**Capacity:** Up to 500KVA

**Parameters:**

- Rated insulation voltage: 1000V.
- Rated operational voltage: 690V.

**Features:**

- Digital control of the rectifier with DSP and internal bus CAN
- LCD graphical display with active mimic diagram
- Continuous operation at full load in all operating conditions
- System lifetime of at least 20 years under continuous operation
- Remote monitoring and diagnostics available
- Advanced Battery Protection
- Wide range of optional extras

## VACUUM CIRCUIT BREAKER (VCB)

**Application:** in 12-36kV power distribution system for control and protection.

**Standards:** IEC 62271-100

**Parameters:**

- Rated voltage: 12-36kV.
- Rated current: 630-3150A.
- Rated short-circuit breaking current: 12-31.5kA

**Features:**

- Compact and modular design.
- Less maintenance.
- High Insulation level and breaking capacity.
- Both withdrawable and fixed types are available.



## AIR CIRCUIT BREAKER (ACB)



**Application:** General applications in all types of low voltage electrical installations.

**Specifications:**

- Rated current: 800 to 6300 A
- Breaking capacity: 42 to 150 kA at 220/415 V AC
- Voltage rating: up to 1150 V AC
- 2 physical sizes: 800 to 4000 A, and 4000 A to 6300 A
- Draw out and fixed mount
- 3-pole and 4-pole construction

**Features:**

- Faultless protection
- Increased uptime with improved coordination with Micrologic electronic trip unit adjustability

# MOLDED CASE CIRCUIT BREAKER (MCCB)

**Application:** General applications in all types of low voltage electrical installations.

**Specifications:**

- Rated current: 16 to 1600 A
- Breaking capacity: 16, 25, 36, 50, 70 kA at 415 V
- Voltage rating: up to 1150 V AC
- 3-pole and 4-pole construction

**Features:**

- Faultless protection
- Increased uptime with improved coordination with Micrologic electronic trip unit adjustability
- Complete selectivity and coordination
- Improved uptime with complete monitoring solution in Smart Panels
- Local and remote communication with trip cause



# MINIATURE CIRCUIT BREAKERS (MCB)



**Application:** General applications in all types of low voltage electrical installations.

**Specifications:**

- Rated current: Up to 63A
- Breaking capacity: Large choice of breaking capacities— up to 100 kA
- Tripping curves: B, C, D, K, Z and MA
- 1-2-3-pole and 4-pole construction

**Features:**

- Faultless protection
- Increased uptime with improved coordination
- High resistance to environmental stresses
- Improved uptime with complete monitoring solution in Smart Panels

# CUT-OUT FUSE/ DROP OUT

**Application:** Protection device for protecting power system from over-load and short-circuit failure.

**Standards:** IEC 60282-2

**Parameters:** Rated voltage: 12-36kV

**Features:**

- High over-current protection capability, high breaking current.
- High industrial frequency Withstand, voltage and mechanical strength, etc.
- High quality on strict testing





## EMS, PFC & PROTECTION RELAY



CAPACITOR



MAGNETIC CONTRACTOR



OVER LOAD RELAY



LIGHTNING ARRESTOR



DIRECT ON LINE (DOL)  
STARTER



APFC RELAY



ENERGY METER



IDMT RELAY



EARTH FAULT RELAY

# BUSBAR TRUNKING SYSTEM (BBT)

## System component:

- Feeder / Transmission lengths
- Plug-in-Feeder / Tap off Feeder
- Joint block with maintenance Freenut
- Riser / Short length

## Direction Arrangement:

- Vertical / Horizontal Elbow
- Vertical / Horizontal offset Elbow
- Combination Elbow
- Vertical Tee Elbow

**Reducers:** Reducer are used for decrease the current carrying capacity.

## Connecting Point:

- Flanged End
- Vertical / Horizontal Elbow with Flanged End
- Vertical / Horizontal offset Elbow with Flanged End
- Plug in / Tap off Box

## Trolley BBT:

- Multiconductor, IP44, Rating : 50A to 300A

**Current Voltage Rating:** 25A to 6300A, 0.415A to 11kV

**Brand:** Schneider, L&T, Graziadio.

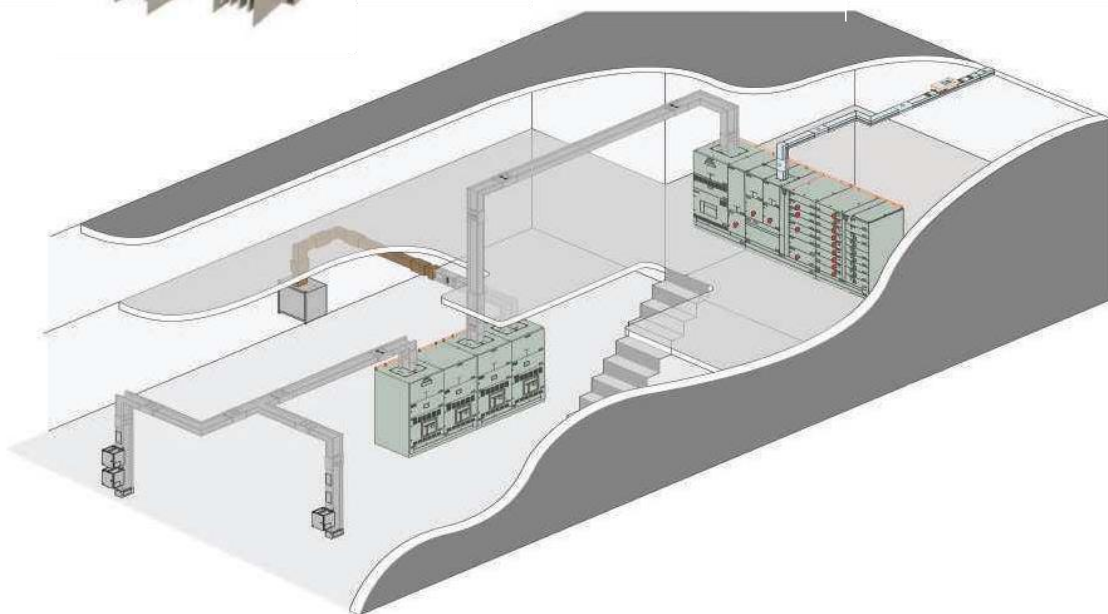

# CABLE TRAY

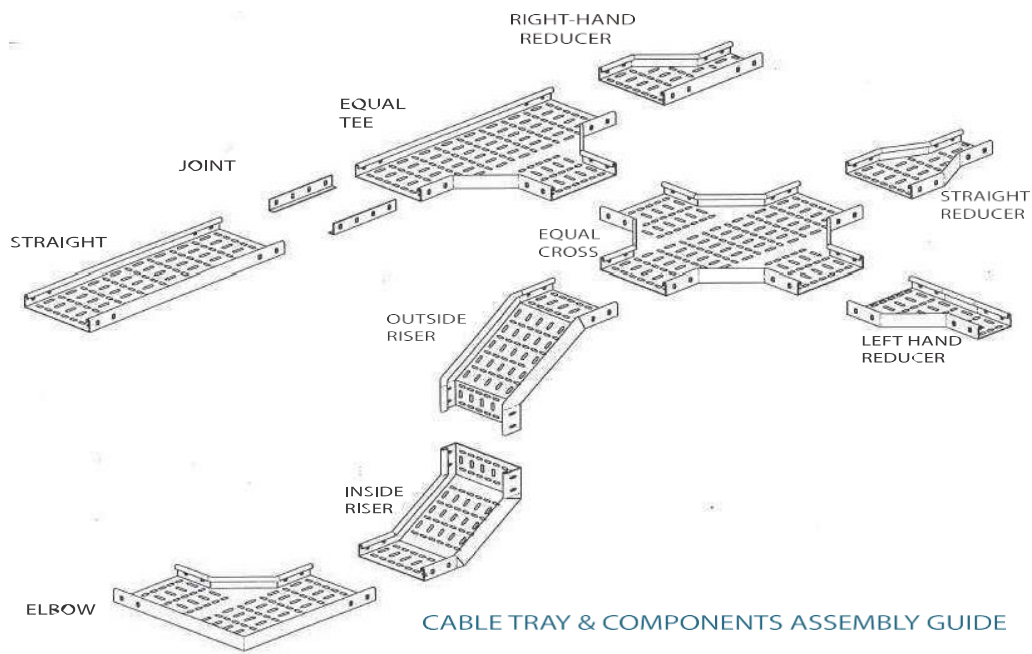

# LIGHTNING PROTECTION SYSTEM

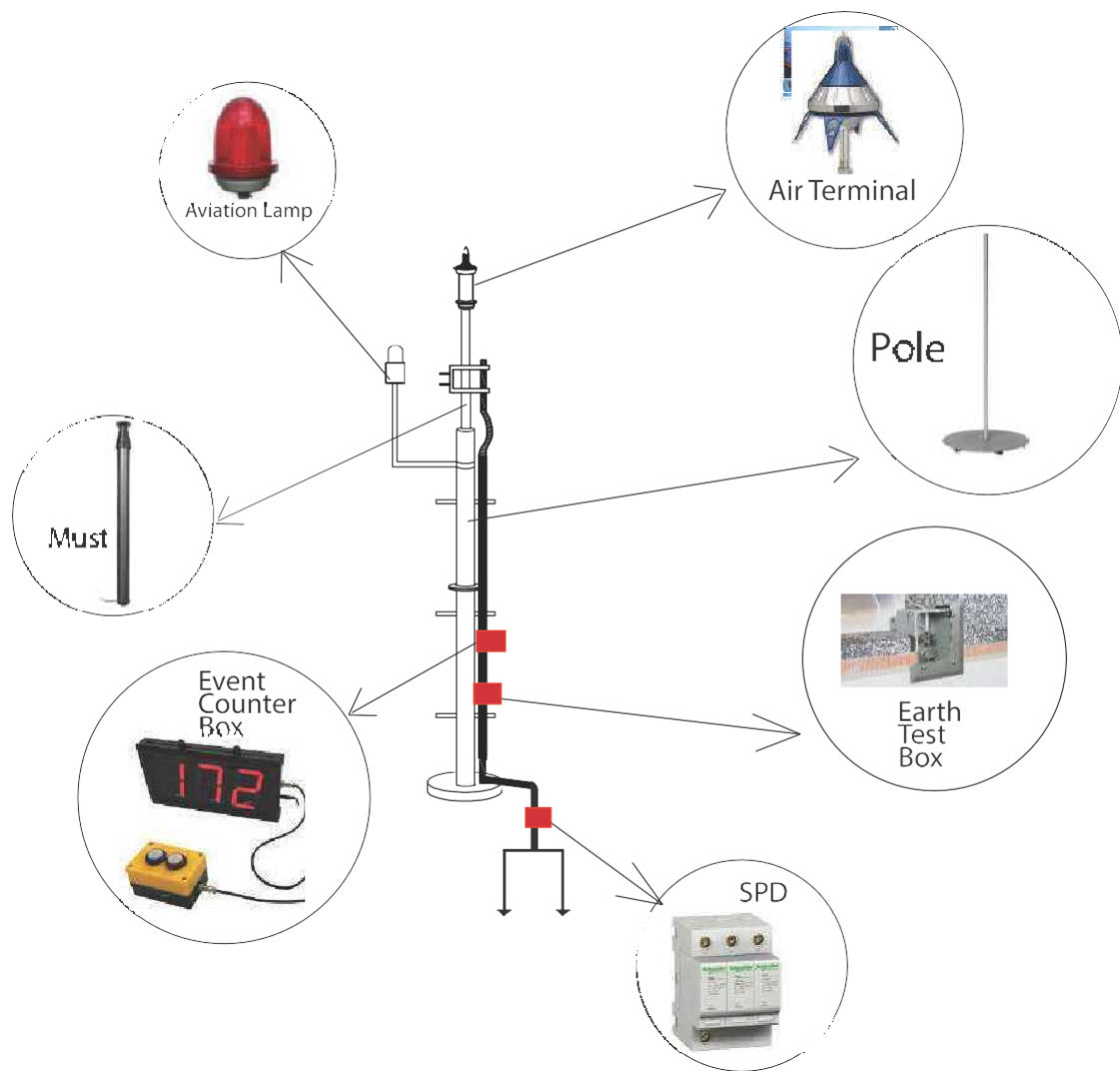

## LPS CONVENTIONAL ARRANGEMENT



# ENERGY / BUILDING MANAGEMENT SYSTEM



## AUTOMATION

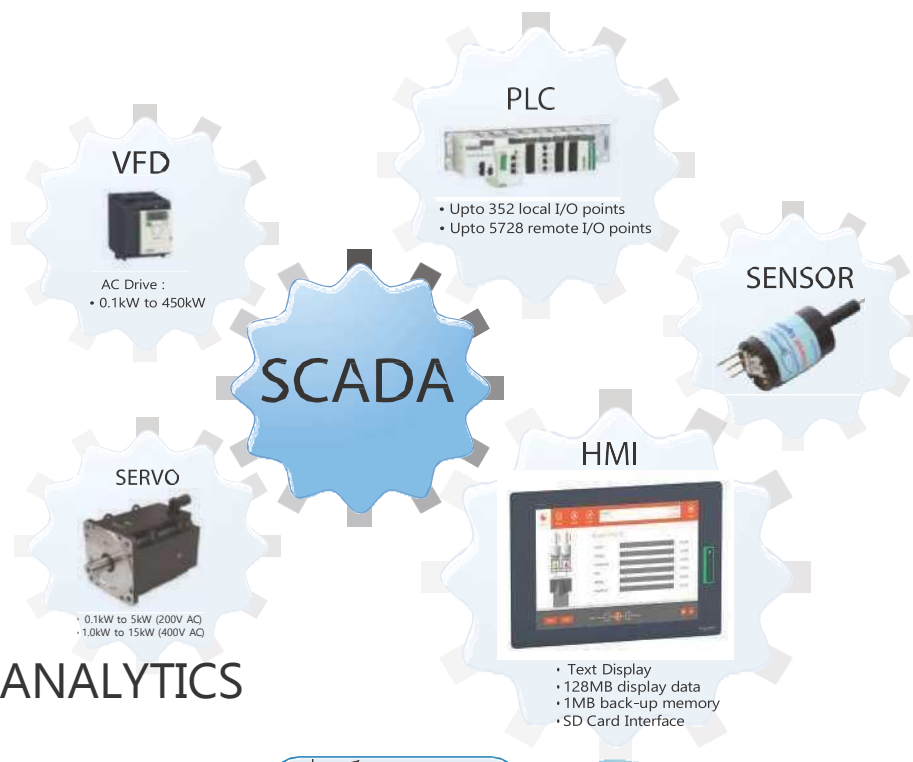

## VIDEO ANALYTICS

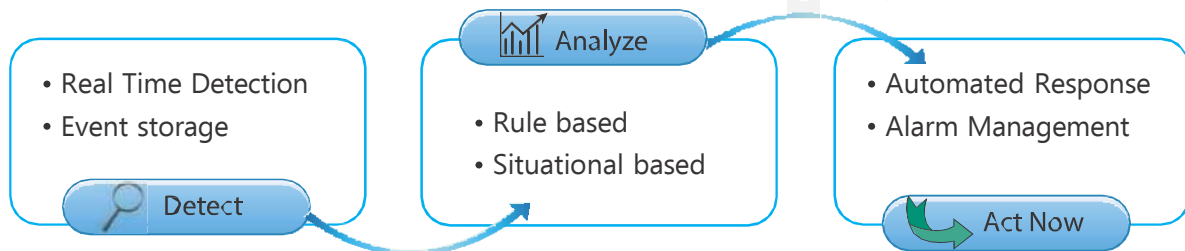



# COPPER BUSBAR - FLAT

Metric (mm)	Imperial (Inches)	kg/m (Nominal)		Alloy C11000 Plain			Alloy C11000 Tinned		
		SE	FR	Square Edge (SE)	Radius Corner (RC)	Full Radius (FR)	Square Edge (SE)	Radius Corner (RC)	Full Radius (FR)
60 x 10		5.36	5.17		50003964	50003977		50004024	50157418
63 x 6.3		3.54	3.47			50003956			50003894
75 x 10	-	6.70	6.51					50157434	
80 x 6.3		4.50	4.42			50004047			50003892
80 x 10		7.14	6.95		50004023	50003955		50004012	50117877
88.9 x 6.35	3 1/2 x 1/4	5.03	4.96	50157539					
100 x 6.3		5.63	5.55			50004046			50003906
100 x 10		8.93	8.74		50004049	50115359		50117516	50066103
101.6 x 12.7	4 x 1/2	11.52	11.21	50003844					
101.6 x 25.4	4 x 1	23.05	21.73	50003849					
120 x 10		10.72	10.52		50003835			50116699	50130390
125 x 6.3		7.03	6.96			50004022			50003927
125 x 10		11.25	11.18					50166130	
152.4 x 12.7	6 x 1/2	17.28	16.97			50160331			
152.4 x 25.4	6 x 1	34.57	33.22	50119893					
160 x 6.3		9.00	8.93			50004021			50003874
160 x 10		14.29	14.10		50004027			50003917	

**Please note:** Other sizes available upon request. **Standard length** : 4000mm





# COPPER ROD, WIRE & STRIP

Metric (mm)	Imperial (Inches)	kg/m (Nominal)	Alloy	
			C11000 High Conductivity Copper	C14700 Free Machining Copper
ROUND				
4.76	3/16	0.16	50003649	
6.35	1/4	0.28	50003650	
9.53	3/8	0.64	50003653	
12.7	1/2	1.13	50003392	50003407
15.88	5/8	1.77	50003393	
19.05	3/4	2.55	50003395	50114703
22.23	7/8	3.47	50003396	
25.4	1	4.53	50003397	
31.75	11/4	7.08	50003508	
38.1	11/2	10.19	50003510	
SQUARE				
10	-	0.89	50135730	

**Please note:** Other sizes available upon request. **Standard length :** 3600mm

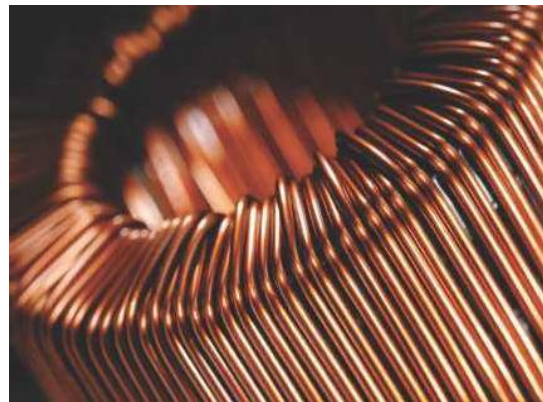

# VALUABLE CLIENTS



## **GRISON POWER ENGINEERING**

*Electrical, Civil, Mechanical & LPG Contractors*

**Head Office:** House-20\18, 4<sup>th</sup> Floor, Paikpara Staff Quarter, Mirpur-1, Dhaka.

**Rajshahi Office:** House-403, Mothurdanga, Sopura, Rajshahi- 6203

**Service Center:** House -20/18, 4th Floor, Paikpara Staff Quarter, Mirpur-1, Dhaka.

**Factory:** Taltoli, Sreepur, Gazipur.

**Contact #** 01775882040, 01625286825

**E-mail:** [grisonpower24@gmail.com](mailto:grisonpower24@gmail.com) **Web:** [www.grisonpowerbd.com](http://www.grisonpowerbd.com)